



**BATHTUBS**

**TECHNICAL SPECIFICATIONS**

CSI Division 06600; 06610; 224223

**\*\*All products made of MasterCast Engineered Composites\*\***

LAST REVISED: 08/11/2011



## Eco Free Standing Tub

**Est. Weight:**

**Est. Water Capacity:**

**USES:**

Std tub with deck:	NO
Undermount:	NO
Drop-in:	NO
Free standing:	YES

**Included Features:**

- Fire retardant
- Solid one-piece construction
- Pre-sloped to drain
- Mold and mildew resistant
- Bacteria resistant
- Non-porous
- Stain resistant and easy to clean
- Waterproof and leakproof

*Our products comply with one or more of the following: IAPMO, ANSI, HUD, NAHB, NHQ*

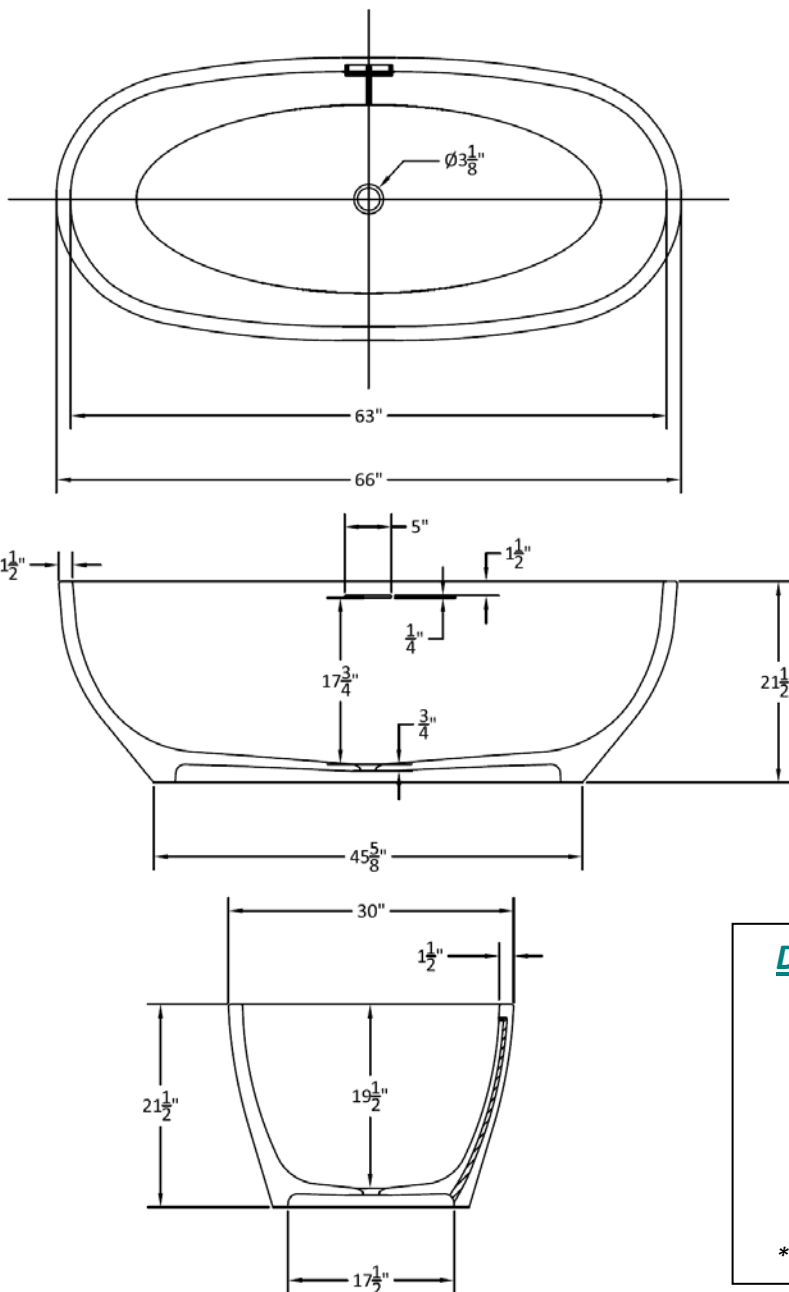

**Drain Details:**

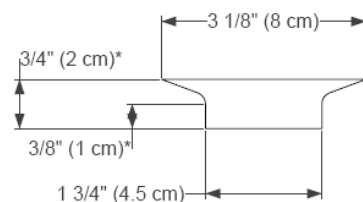

*\* dimensions may vary slightly*